

FACT SHEET



Location

- The hotel occupies a perfect City Centre location for Business and Leisure Travel.
- Minutes away from the financial district, International Convention Centre, National Indoor Arena, Symphony Hall and Hippodrome Theatre.
- The superb Mailbox, Selfridges and Bullring Shopping complex are within walking distance from the hotel.
- Birmingham offers excellent road and rail connections to all major UK destinations.
- Birmingham International Airport hosts 50 airlines serving approx 60 non stop routes within UK, Europe, America and the Middle East.
- Birmingham New Street Station is a 3 minute walk from the hotel.

Food & Beverage

- Filini Bar & Restaurant serves up a whole new food philosophy as its menu innovatively blends Sardinian flavours with Mediterranean classics.
- Located in the lobby area, The Bar is the perfect place to unwind.
- The hotel offers Super Breakfast Buffet & Grab and Run concepts.

Rooms

- 211 Guest bedrooms including seven stylish suites and a Presidential Suite.
- Three unique room styles: Chic, Fashion and Fresh designed by Italian designer Matteo Thun.
- Free High Speed Internet access for all residential guests.
- In-room amenities include air-conditioning, pay-TV, mini bar, safe, tea and coffee making facilities.
- Flexible bed stock of Twin/Double, Zip & Link.
- Located on the 18th floor of the hotel is the ultimate urban treat. Pamper yourself from head to toe and be transported into the calm and tranquility that is the Obsession Spa.

Meetings

- The second and third floors of the hotel are dedicated to meeting and events totalling approx 366m².
- 10 flexible and fully-equipped meeting and event rooms.
- The main event room is 108m² (and is divisible by 3).
- All rooms provide natural daylight via floor to ceiling windows.
- Full audio and visual facilities including Wireless LAN.
- Fully-equipped Business Centre with a dedicated host offering the ideal environment for your conference or special event.

Radisson SAS Hotel

12 Holloway Circus, Birmingham, B1 1BT, United Kingdom
Tel: +44 (0) 121 654 6000, Fax: +44 (0) 121 654 6001
info.birmingham@radissonsas.com
birmingham.radissonsas.com

Conference & Meeting Facilities

2nd floor

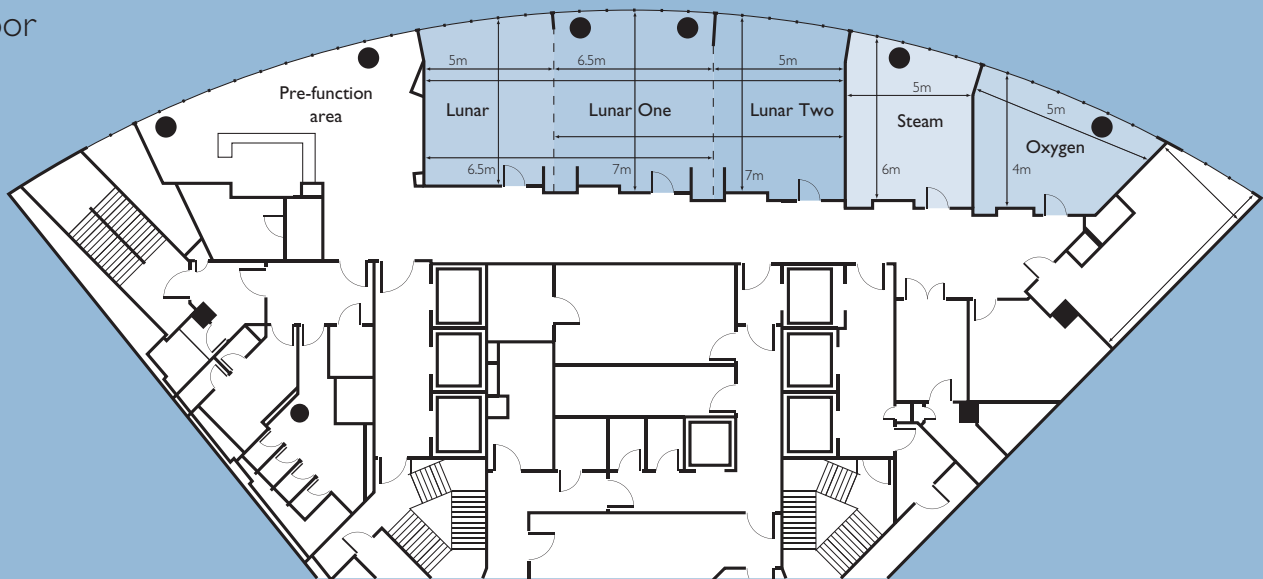

3rd floor

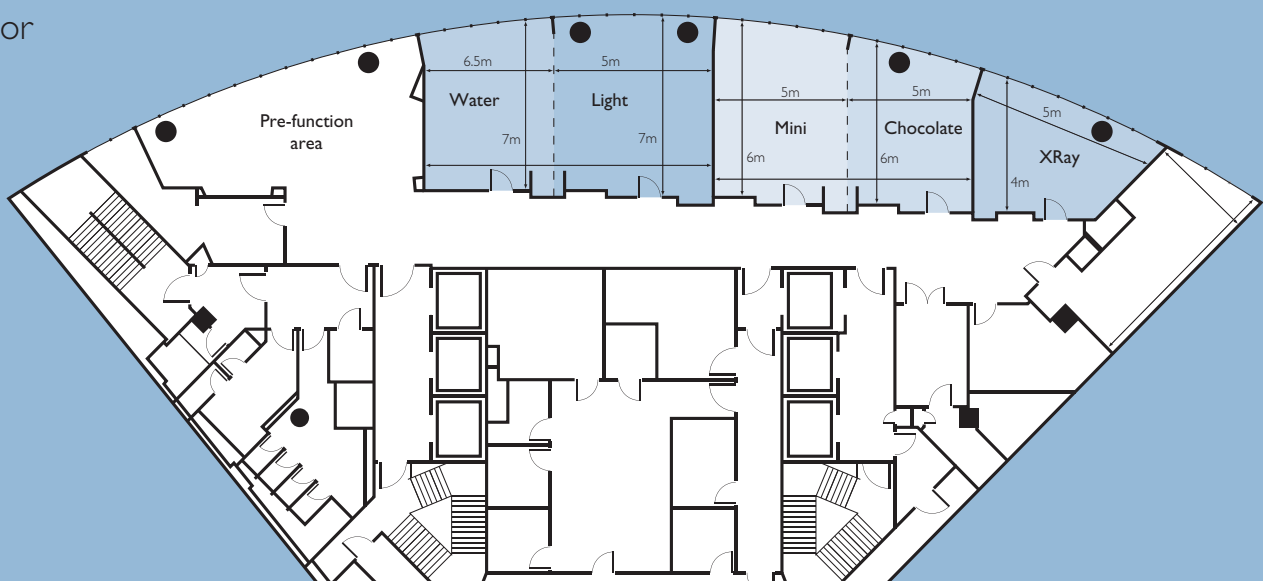

	Size in m ²	Cocktail	Theatre	Cabaret	Classroom	U-shape	Boardroom	Banquet
2nd floor								
Lunar Suite*	108	150	130	56	48	50	40	88
Lunar	32	45	25	21	12	12	12	24
Lunar One	42	45	35	21	12	14	16	24
Lunar Two	34	35	25	21	12	12	12	24
Steam	30	25	20	-	9	12	10	-
Oxygen	30	-	-	-	-	-	10	-

*Lunar, Lunar One and Lunar Two can be combined to create the Lunar Suite.

	Size in m ²	Cocktail	Theatre	Cabaret	Classroom	U-shape	Boardroom	Banquet
3rd floor								
Water & Light combined*	75	85	60	28	30	27	30	44
Water	32	35	25	14	12	14	16	16
Light	42	45	35	21	12	14	16	24
Mini & Chocolate combined*	66	70	50	21	24	24	26	33
Mini	36	35	25	14	12	14	12	16
Chocolate	30	-	20	-	9	12	10	-
XRay	30	-	-	-	-	-	10	-

*Water & Light Room can be combined to create a larger room.

*Mini & Chocolate Room can be combined to create a larger room.